



# BMH40A Material Handler Grapple



## Get Our Grip.

Hard To The Core Brandt Material Handler Grapples are purpose built to pair with the BMH40A. With more configuration options, simple maintenance requirements, and the capability to handle scrap with ease, you can count on Brandt Material Handler Grapples to tackle any task.

### ① Higher Productivity

Impeccable timing to get more done:

- 4- and 5-tine configurations are available in multiple tine styles.
- Grapple body structure provides more strength in a reduced weight attachment.
- Fully boxed tine construction utilizes alloy steel bushings and pins, as well as fully sealed pin joints.

### ② Increased Uptime

Scrap downtime with smart design:

- Hydraulic hose and cylinder guarding is easy to remove and replace.
- Rotary manifold is easily removed from the top of the attachment to simplify service.
- Mechanical stops prevent cylinder overextension.

### ③ Lower Operating Costs

Go ahead. Test its mettle:

- Alloy tine tips are oversized to deliver extended service life and are replaceable when wear does occur.
- Internal pressure relief and overload protection are built in.
- Heavy-duty slew ring with continuous high torque 360° rotation.

# BMH40A MATERIAL HANDLER GRAPPLE SPECIFICATIONS

## 4-TINE

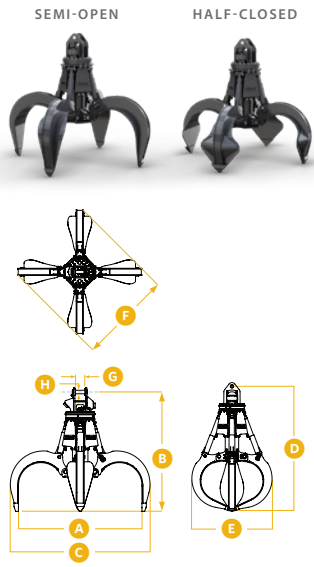

## 5-TINE

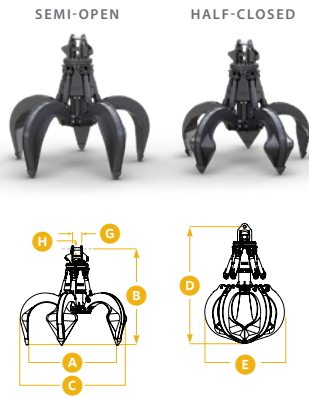

## MAGNET



## MAGNET LIFTING DEVICE FOR USE WITH GRAPPLE

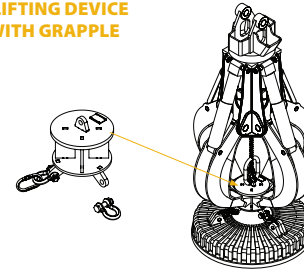

CONFIGURATION	4-TINE			5-TINE	
<b>MODEL (BSG-)</b>	<b>100-4S</b>	<b>100-4H</b>	<b>125-4S</b>	<b>100-5H</b>	<b>125-5H</b>
Capacity (yd <sup>3</sup> )	1.00	1.00	1.25	1.00	1.25
Shell Style	Semi-Open	Half-Closed	Semi-Open	Half-Closed	Semi-Open
Weight (lb)	3490	3700	4010	4130	4630
Rot. Torque (ft-lb)	1335	1335	1335	1335	1335
Pressure (psi)	4500	4500	4500	4500	4500
Flow (gpm)	77	77	77	77	77
<b>A</b> Opening Tip-to-tip (in)	88	88	94.5	88	94
<b>B</b> Open Height (in)	85	85	91	87	92.5
<b>C</b> Open Width (in)	99.5	99.5	109.5	100	110
<b>D</b> Closed Height (in)	101	101	101	103	109.5
<b>E</b> Closed Width (in)	65.5	65.5	76.5	68	77.5
<b>F</b> Diagonal (in)	74.5	74.5	81.5	N/A	N/A
<b>G</b> Frame Width (in)	6.63	6.63	6.63	6.63	6.63
<b>H</b> Pin Diameter (in)	2.5	2.5	2.5	2.5	2.5

CONFIGURATION	MAGNET
<b>I</b> Diameter (in)	60
<b>J</b> Height (in)	12
<b>K</b> Height w Chains (in)	45
Net Weight (lb)	5070
Output (kW)	12.5
Voltage (V)	230
Duty Cycle	80% Continuous
<b>LIFTING CAPACITY (LB)</b>	
Slab Lifting	49,603
Pull-off Strength	101,164
Pig Iron	3086
Chips	1146
Light Scrap	2116
Heavy Scrap	2425

CONFIGURATION	MAGNET LIFTING DEVICE FOR USE WITH GRAPPLE	
<b>MODEL</b>	<b>4-TINE</b>	<b>5-TINE</b>
Weight (lb)	231	238

For more information:  
 Call us at **1-888-227-2638**  
 Email us at **sales@brandt.ca**  
 Or visit us at **brandt.ca**

© Brandt Industries Ltd. All rights reserved. The Brandt name and logo are trademarks of Brandt Industries Ltd., used under license. All product information and specifications are subject to change without notification. Printed in Canada. Revised 04/2024-CU

